



RK ROSE+KRIEGER

A Phoenix Mecano Company



RK Slimlift / EM

Two-stage lifting column

Two-stage lifting column - *RKSlimlift* / *EM*

Rod-shaped design and extremely quiet operation



Features:

General

- Excellent installation height/stroke length ratio
- Self-locking, even at max. load
- Fixing slots in external profile

Options:

- Version with manual drive via crank handle
- Further stroke lengths available on request
- Quadro control enables control of up to 32 columns synchron

Table of contents - *RKSlimlift*

Properties/Technical data

- General information/operating conditions..... Page 48

Versions (dimensions, order no.)

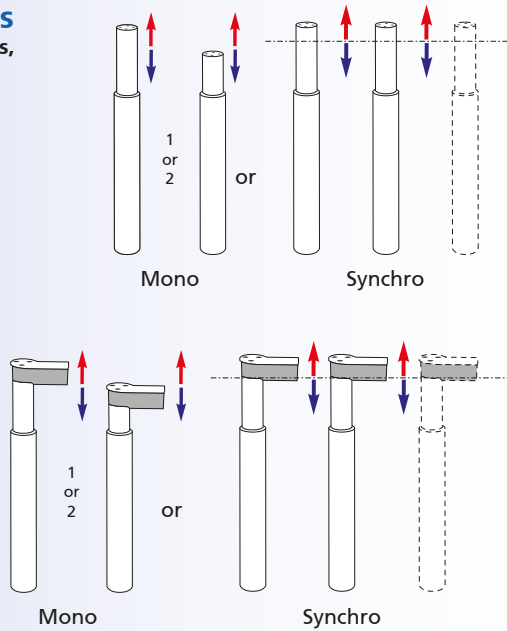

- *RKSlimlift*..... Page 50

- *RKSlimlift EM* Page 51

Accessories

Fixing

- Levelling foot for RKSlimlift EM Page 52
- Foot..... Page 52
- Square nut Page 53
- Profile adaptor Page 53

Position determination

- Controls Page 56
- Hand switches Page 57

General information / operating conditions

Design	Rod-shaped lifting column, optionally available with external drive motor (<i>RK Slimlift EM</i>)
Guide	Preset sliding elements made of plastic
Installation position	Any position/suspended with drop protection provided by the customer
Push force	Choice of 1,000 N/4,000 N
Pull force	Choice of 500 N/1,000 N/2,000 N
Voltage	36 V DC
Power input	144 W = Slimlift/ 108 W = Slimlift EM
Protection class	IP 30
Self-locking	Yes
Ambient temperature	+5°C to +40°C
Max. displacement with synchronous operation	0-3 mm/0-1.5 mm
Duty cycle	At nominal load, 15% (max. 1.5 mins operating time, 8.5 mins rest time)

Note:

All information refers to the standard sizes. All data of push/pull forces are referring to the individual lifting column, for combined applications a safety factor of up to 0,6 has to be considered.

Load data

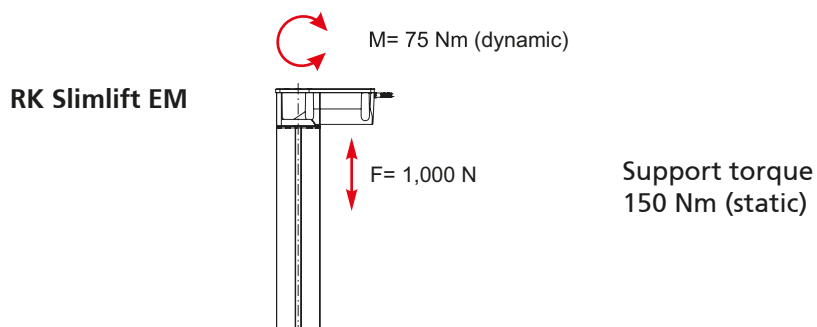
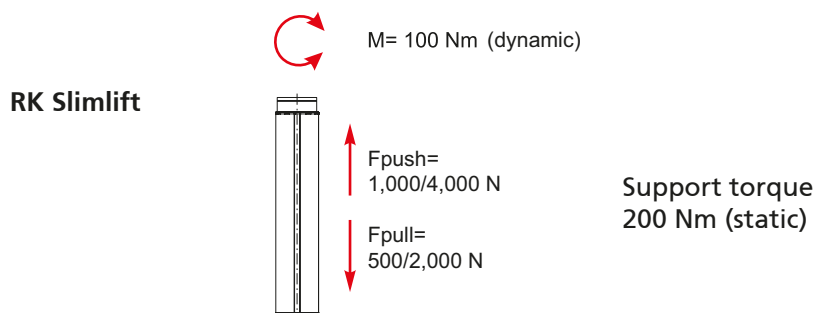

Slimlift Mono

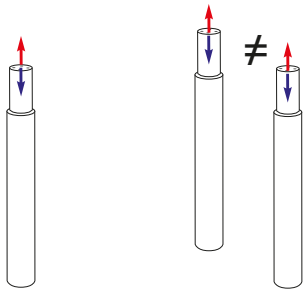

1-2 Slimlifts in single or parallel operation

Parallel operation

The standard version also supports parallel operation of two Slimlifts (no synchronisation). This may produce different lifting positions during operation, which can be levelled out by moving to the end positions.

Slimlift Synchro

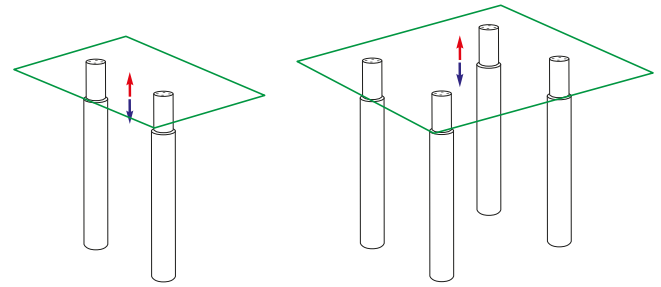

2-4 Slimlifts in synchronous operation

Synchronous operation

Synchronous operation of two or more columns. In conjunction with the integrated sensors, the control (see page 148) ensures synchronisation, and thus constant alignment of all the columns in both directions of travel, even if subject to different loads. The synchronous operation tolerance depends on the lifting speed and is max. 1.5 mm for the 8 mm/s version and max. 3 mm for the 25/32 mm version. A memory function is also available.

RKSlimlift – Versions

RKSlimlift

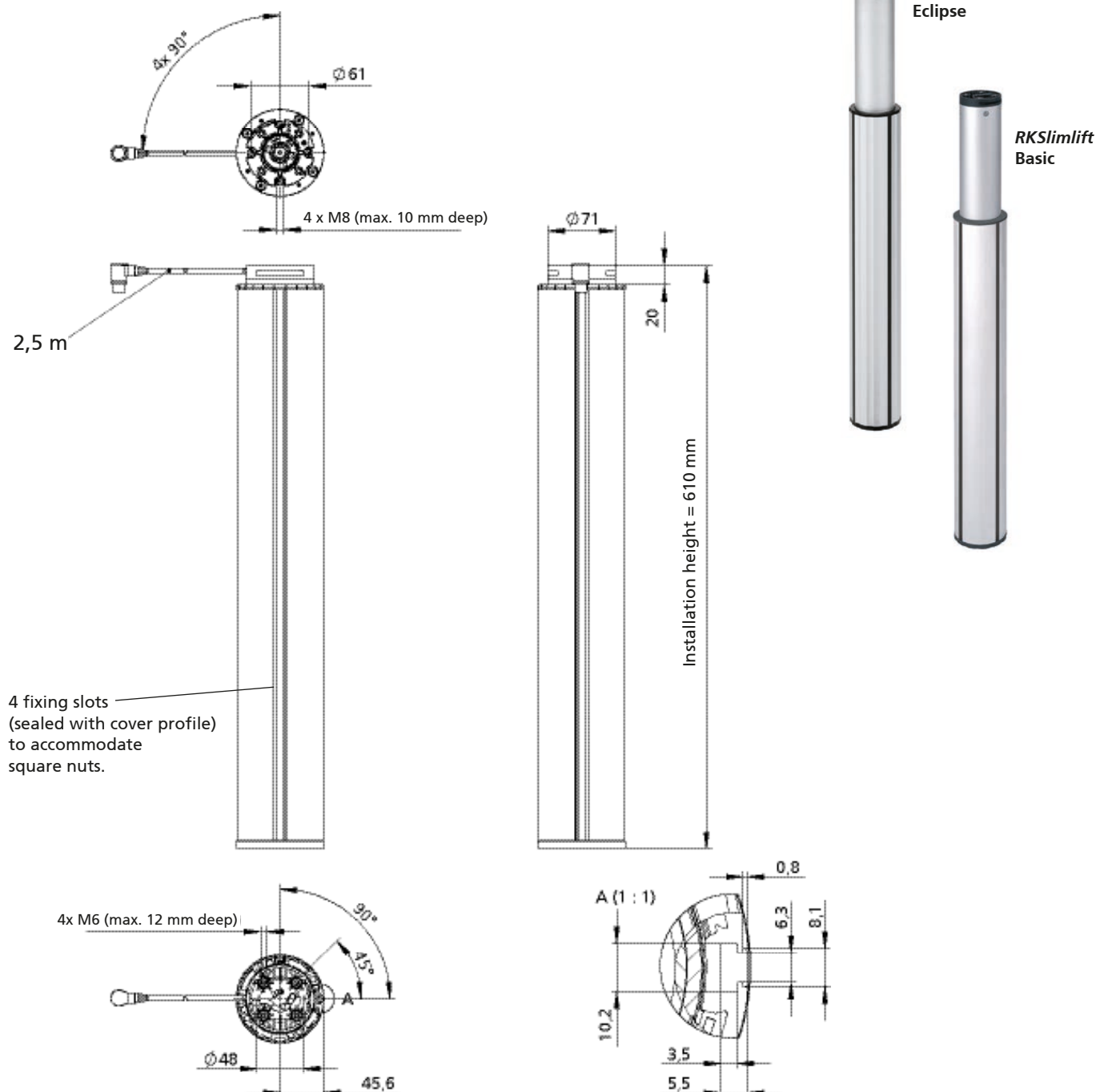

Mono and synchro

Code No.	Type	Push force [N]	Pull force [N]	Lifting speed [mm/s]	Stroke length [mm]	Installation height [mm]	Weight [kg]
QSL32BA130460	RKSlimlift Eclipse	1,000	500	32	460	610	6.0
QSL32BA330460	RKSlimlift Basic	1,000	500	32	460	610	6.0
QSL10BD200285	RKSlimlift Basic	4,000	2,000	8	285	610	7.0

RK Slimlift EM

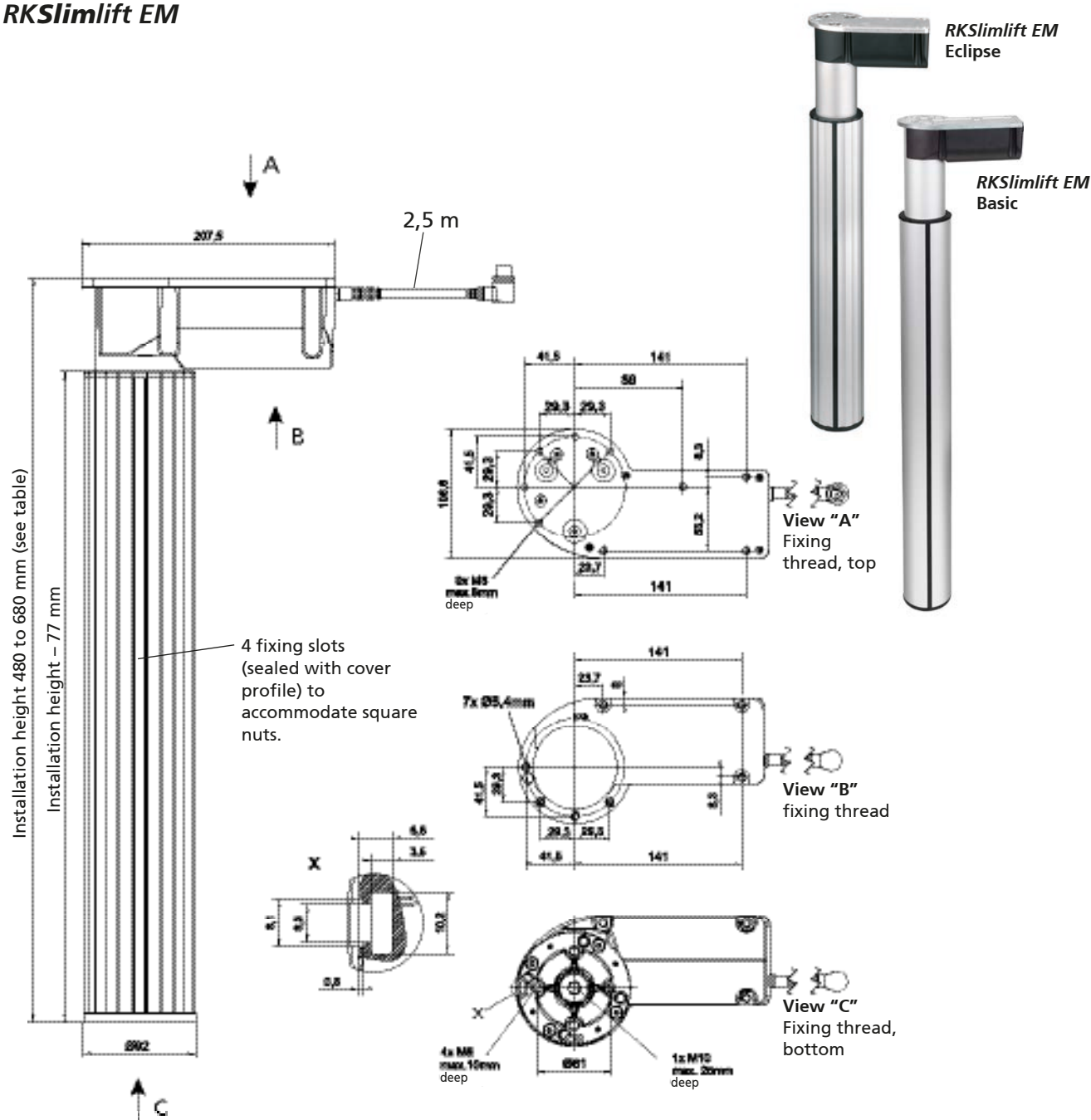

Mono and synchro

Code No.	Type	Push force [N]	Pull force [N]	Lifting speed [mm/s]	Stroke length [mm]	Installation height [mm]	Weight [kg]
QSL25BA270300	RK Slimlift EM Basic	1,000	1,000	25	300	480	~4.5
QSL25BA170300	RK Slimlift EM Eclipse	1,000	1,000	25	300	480	~4.5
QSL25BA270400	RK Slimlift EM Basic	1,000	1,000	25	400	580	~5.3
QSL25BA170400	RK Slimlift EM Eclipse	1,000	1,000	25	400	580	~5.3
QSL25BA270430	RK Slimlift EM Basic	1,000	1,000	25	430	610	~5.5
QSL25BA170430	RK Slimlift EM Eclipse	1,000	1,000	25	430	610	~5.5
QSL25BA270500	RK Slimlift EM Basic	1,000	1,000	25	500	680	~6.0
QSL25BA170500	RK Slimlift EM Eclipse	1,000	1,000	25	500	680	~6.0

RK Slimlift – Fixing

Levelling foot (for Type EM)

- The foot can be bolted centrally into the base plate of the RK Slimlift EM.

Material: steel parts zinc plated
Pivot plate PA, black

- Max. screw-in depth 25 mm

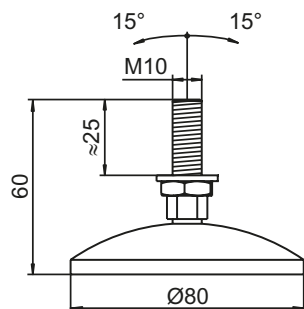

Code No.	Type
QZD120340	Levelling foot

Foot

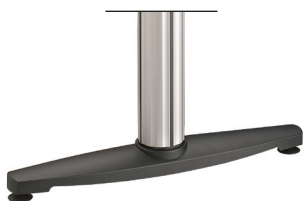

- Both foot versions can be bolted to the external profile without the need for any further modifications

Material: GK-ALSi12/3.2583.02,
black powder-coating

Max. load 1,000 N

Type 1

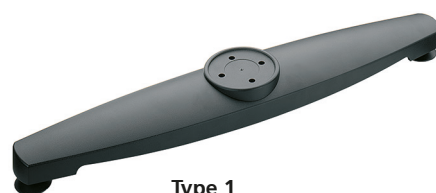
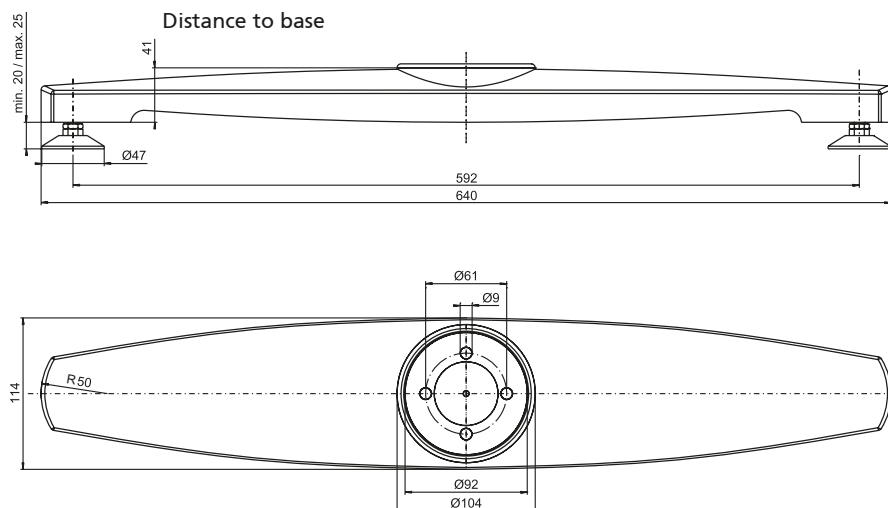

Type 1

Type 2

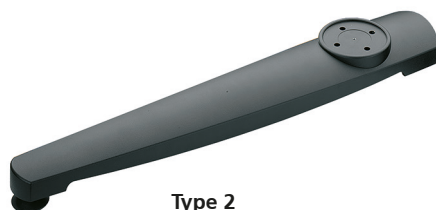
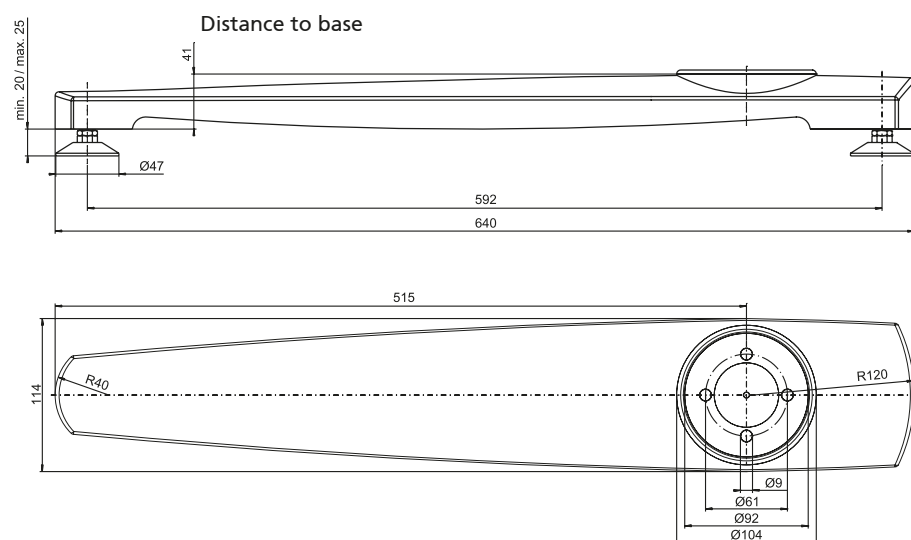

Type 2

Code No.	Type
QZD120341	1
QZD120342	2

Order instruction square nut:

- Purchase only in lot sizes and a multiple of that, see product table below

Square nut



- For connecting accessories to the external profile

Material: zinc plated steel

Code No.	lot sizes	Type
qzd0505971	10, 20, 30... pcs	Square nut M6, DIN 562

Profile adaptor

Fixed build

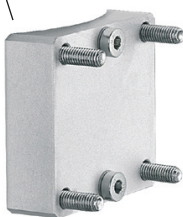

- The profile adaptor allows several lifting columns to be together to form a stable combination. In this way, and with minimum effort, four columns can be connected to form lifting tables and operated via a synchronous control (MultiControl quadro). The aluminium profiles F-60/1, F-60-L, F-G 60, F-2G 60 from the BLOCAN® Profile Assembly System are suitable as struts for this purpose.

Material: AlMgSi, clear anodised, zinc plated fastenings

Scope of delivery: one profile adaptor with fastenings for attachment to one end of the profile

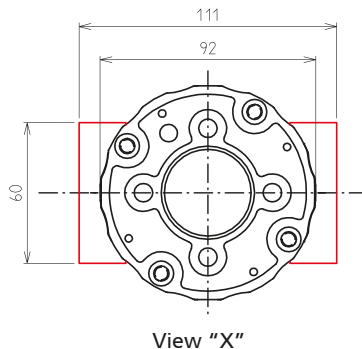
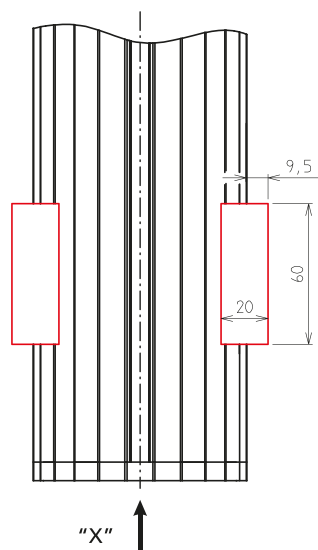

Connection example

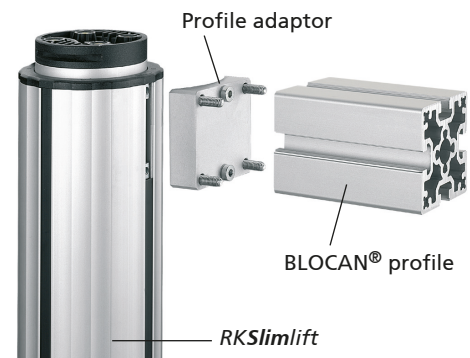

Application example:

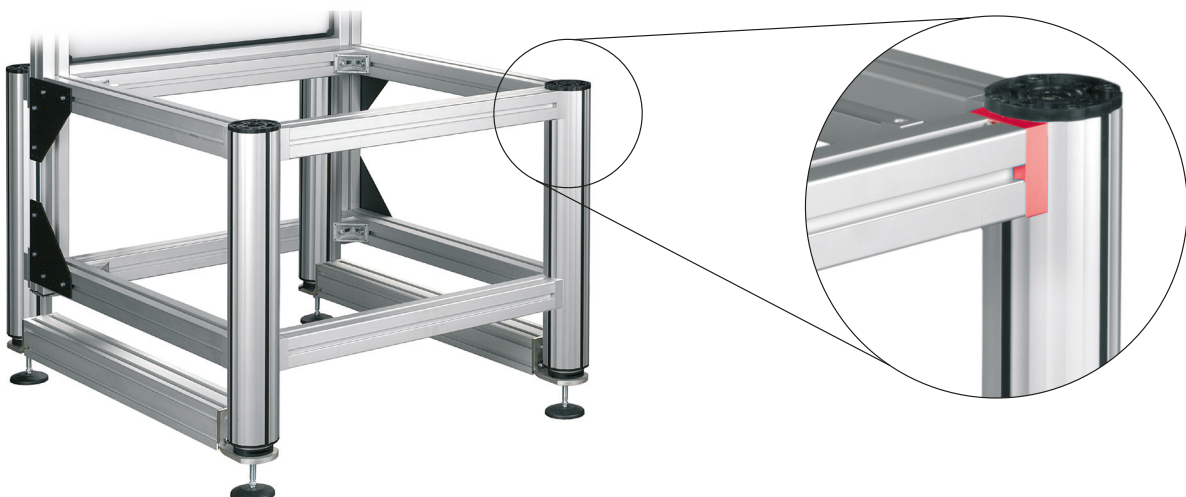

Code No.	Type
QZD120256	Complete profile adaptor

Fixing plate (not for EM)

■ This universal plate can be bolted directly into the screw channel of the lifting column using a fixing set. The numerous pre-drilled holes in the metal make it easy to attach table tops, brackets, etc.

Material: steel, black powder-coated (RAL 9005), zinc plated fastenings

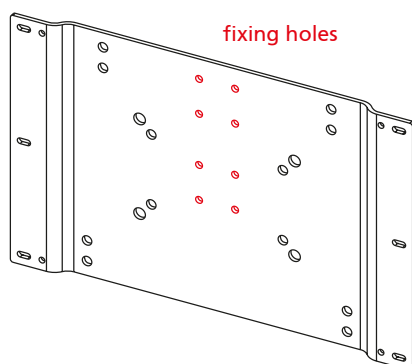

fixing holes

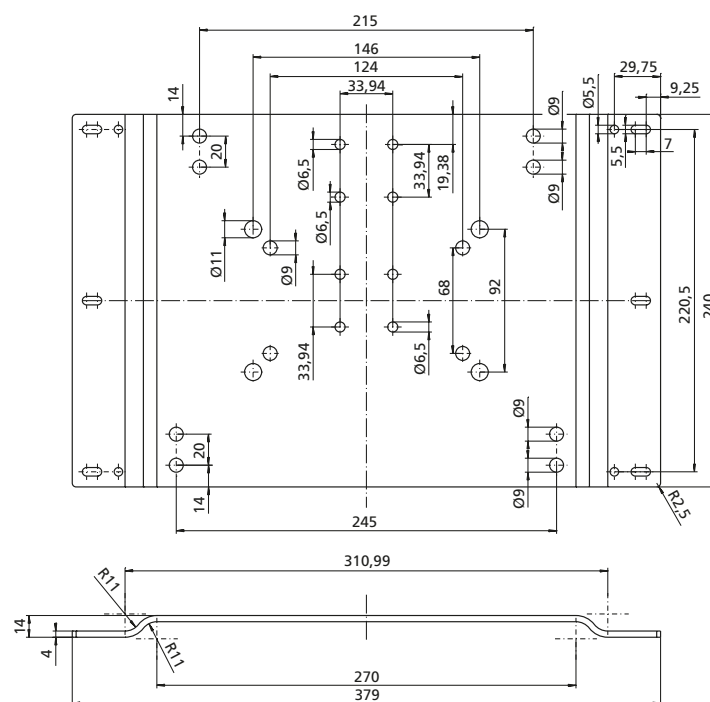

Code No.	Version
QZD100313	Fixing plate
QZD120336	Fixing set, 4x M6 x 14, DIN 7984



Controls

- Input voltage 230 V AC
- Output voltage 24/36 V DC
- For battery operated controls

MultiControl



approx. 36 V DC

For dimensions and other technical data, please refer to the chapter "Motors and controls"

Code No.	Version	
Controls for <i>RK Slimlift</i> mono		
QSTACCA1AA000	MultiControl mono connection C, up to max. I = 12 A current output, 36 V DC	Controls up to 2 drives
Controls for <i>RK Slimlift</i> synchro		
QST20C02AA000	MultiControl duo connection C, 12 A current output at 20% duty cycle	1-2 drives synchronised
QST21C02AA000	MultiControl duo connection C for RK Slimlift EM, 12 A current output at 20% duty cycle	1-2 drives synchronised
QST20C04AA000	MultiControl quadro connection C, 12 A current output at 20% duty cycle	3-4 drives synchronised
QST21C04AA000	MultiControl quadro connection C for Slimlift EM, 12 A current output at 20% duty cycle	3-4 drives synchronised
Accessories		
QZD100093	6 m bus cable for the networking of up to 8 synchronous controls	
QZD0702844000*	Straight connecting cable (4 m) with 5-pin connector and open cable end	
QZD070526	Extension cable 2.5 m drive for connector C/8-pin DIN socket	

*for the connection of a parallel hand switch or an external potentiometer (in the case of the MultiControl mono)

Hand switches/accessories

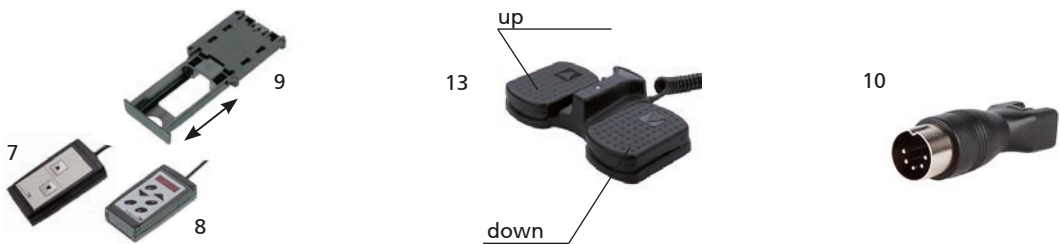

Note: For further hand switch versions, please refer to the chapter “Controls” on page 148

Code No.	Version	Fig.
Hand switches for transformer or synchronous control		
QZB11G07AB041	Hand switch with 2 function keys – 1 m spiral cable*	7
QZB02C01AE114	Foot switch – 2 function keys	13
Hand switch for synchronous control		
QZB00D04AD041	Hand switch with 1 m spiral cable – 6 function keys	8
Accessories for hand switches		
QZD000074	Hand switch drawer: Fig. 7 + 8	9
QZD070750	Adapter DIN 5pin to Molex 6pin	10

*When using the manual switch with 2 function keys **QZB11G07AB041** on the MultiControl I the adapter DIN 5pin to Molex 6pin **QZD070750** is required.

We say what we do - and do what we say!
We also say what we can't do - and don't do it!



RK ROSE+KRIEGER

A Phoenix Mecano Company

Connecting and positioning systems

RK Rose+Krieger GmbH
Postfach 15 64
D-32375 Minden
Telephone: +49 (5) 71/9335-0
Fax: +49 (5) 71/9335-119
E-Mail: info@rk-online.de
Internet: www.rk-rose-krieger.com